

gentoo

PRODUCT DATA SHEET

Denver reception straight base unit 1600mm - beech with white panels



RU16D-BWH

The reception area is of critical importance for any business. It needs to be a welcoming space for all visitors, from valued customers to prospective new starters arriving for an interview. Available in beech with optional white panels, Denver is a flexible modular unit that can be arranged in a variety of configurations with the base and top units to create a commanding reception feature that will make a lasting first impression.

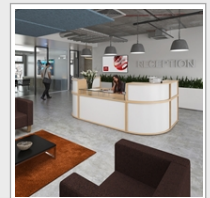
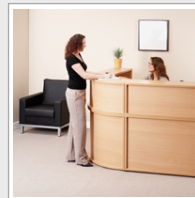

PRODUCT FEATURES

- High quality, front office reception desk base unit 1600mm wide
- Robust unit with 2mm ABS edging and cable access ports that align with hutch units
- Available in beech and beech with white panels
- 25mm melamine beech surfaces which are scratch and heat resistant
- Adequate storage so the area appears uncluttered and there's plenty of room to work
- Create multiple desk configurations where many important tasks are carried out

DIMENSIONS & SPECIFICATIONS

Height	Width	Depth
742mm	1600mm	800mm

RRP: £433.00

Bar Code: 5019904465056

Conforms to:

Colour: Beech/White

Warranty: 5 years

Pack Quantity: 1

Weight (Kg):